

## Below Grade Waterproofing from Positive side

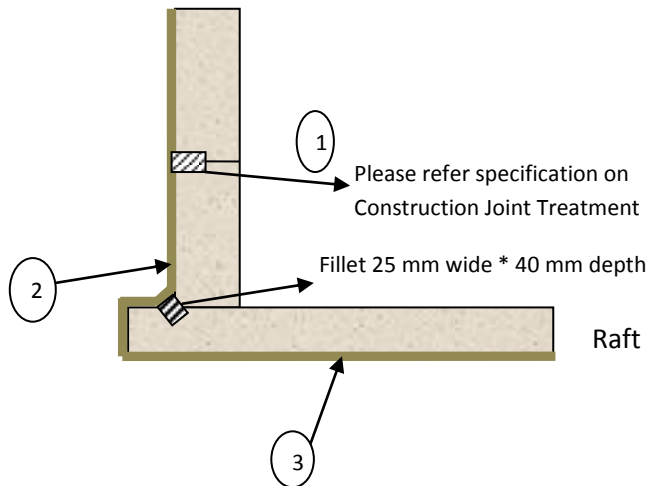

- ① Joint Treatment/Tie Rod Treatment
- ② MITA Coating
- ③ MITA Coating

### Application Instructions:

- 1) Clean with high water pressure all concrete surfaces.
- 2) Complete Joint Treatment Procedures as per specifications.
- 3) Complete Honey combed Treatment Scheme as per specifications.
- 4) Apply MITA slurry at  $1\text{kg/m}^2$  to all water washed (SSD conditions) surfaces.
- 5) Cure coated surface with clean water for 5 days.